

KLS23-GMP24-TEC2419 24mm Planetary Gearbox plus 24mm brushless motor

- Small size dc gear motor with low speed and big torque
- 24mm gear motor provide 1.0 Nm torque and more reliable
- Suitable to small diameter, low noise and big torque application
- Reduction Ratio: : 4、19、27、51、71、100、139、189、264、369、516、720

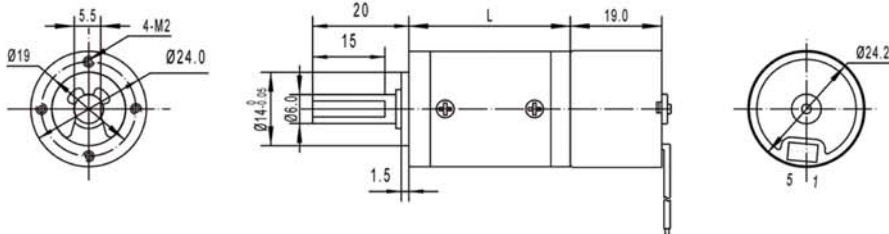

Gear Motor Dimensions (mm)



Motor Technical Data

Motor model No.	Rated voltage	No-load speed	No-load current	Rated speed	Rated torque	Rated current	Output power	Stall torque	Stall current
	VDC	r/min	mA	r/min	g.cm	mA	W	g.cm	A
TEC2419-1262	12.0	6200	90	4800	20	180	1.4	105	0.75
TEC2419-2487	24.0	8700	70	7000	20	150	2.5	130	0.70

Gear motor Technical Data

Gearbox with motor: GMP24-TEC2419-1262-XXX

	19	27	51	71	100	139	189	264	369	516
Reduction ratio	19	27	51	71	100	139	189	264	369	516
Length mm	36	36	42	42	42	42	49	49	49	49
No-load speed rpm	300	210	120	85	60	44	31	22	15	11
Rated speed rpm	250	175	90	65	45	32	24	17	12	9
Rated torque kg.cm	0.2	0.3	0.6	0.8	1.2	1.6	1.8	2.6	3.6	5
Max.momentary tolerance torque kg.cm	1	1.5	2.5	3	5	10	10	10	10	10

Gearbox with motor

GMP24-TEC2419-2487-XXX

	19	27	51	71	100	139	189	264	369	516
Reduction ratio	19	27	51	71	100	139	189	264	369	516
Length mm	36	36	42	42	42	42	49	49	49	49
No-load speed rpm	440	310	160	120	85	60	45	32	22	16
Rated speed rpm	350	245	130	90	65	50	35	25	18	13
Rated torque kg.cm	0.2	0.3	0.6	0.8	1.2	1.6	1.8	2.6	3.6	5
Max.momentary tolerance torque kg.cm	1	1.5	2.5	3	5	10	10	10	10	10