

CENTER HOLE DETAIL

SHAFT DETAIL

SEC:Y-Y

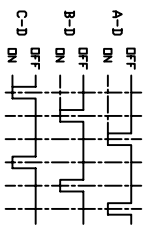
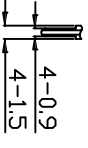

Electrical Characteristics
 Rated Power: DC5V 5mA Max.
 Output signal: A \ B \ C 3signals
 Resolution: 10 Pulses 360°
 Phase difference: 0.08T Min.
 Sliding noise: 3ms Max.
 Contact Resistance: 1Ω Max.
 Insulation resistance: 100MΩ Min. at DC 250V
 Withstand voltage: AC300V / 1min

Mechanical
 Total rotation angle: 360°
 Rotation torque: 170±50gf.cm
 Push-pull Strength of Shaft: 8.0kgf Min.
 Number of Detents(Click): 30 detents Step angle:12°±2°
 Shaft play in axial direction: 0.4mm Max.
 shaft play in rotational wobble: 5° Max.
 Rotational Life: 30000±200 cycles
 Temp. Range: -40 ° C ~ + 85 ° C
 Soldering: 250 ° C 5sec. Max.

GENERAL TOLERANCE	ANGLE TOLERANCE	PROJECTION	Description:
X: ±0.50	X: ±5°	mm	35MM Ring type Encoder
.X ±0.38	.X ±3°	A4	
.XX ±0.25	.XX ±2°	KLS P/N:	

Draw by: Date	Check by: Date	SCALE	SHEET	OF
2015-09-01	2015-09-15			

TERMINAL DETAIL

OUTPUT SIGNAL (CW ROTATION)

KLS ELECTRONIC CO., LTD.

KLS4-RT3502