

SECTION A-A

Material
 Strapsnel: Stainless steel
 Pin header: Brass, Tin plated
 Housing: PA66, UL94V-0

Electrical
 Rated voltage: 300V
 Rated current: 10A
 Wire range: 22~16AWG 1.5mm²
 Contact Resistance: 20 mΩ
 Insulation resistance: 500MΩ/DC500V
 Withstand voltage: AC2000V / 1min

Mechanical
 Temp. Range: -40 °C ~ +105 °C
 Soldering: 250 °C±5 °C for 5S
 Strip length: 9~10 mm

Order Information

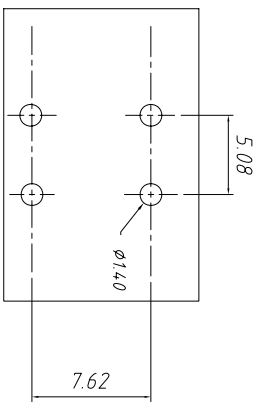
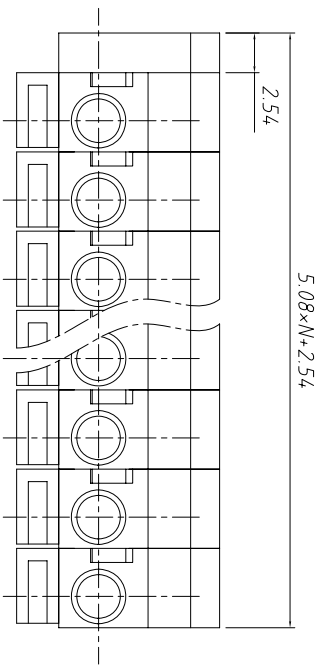
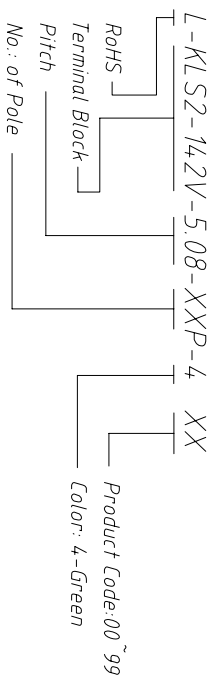

PCB LAYOUT

GENERAL TOLERANCE		ANGLE TOLERANCE		PROJECTION		Description:	
X: ±0.60	.X ±0.38	.XX ±0.25	X: ±5°	.X ±3°	.XX ±2°		UNITS
Draw by: Date			2015-09-01				Spring Clamp Terminal Block 5.08mm
Check by: Date			2015-09-15				
SCALE			SHEET OF				
KLS ELECTRONIC CO., LTD.							