

Material:

Connector body: Brass, Salt Spray 48H

Center Contact: Brass, Gold Plating

Crimp Ferrule: Nickel Plate, Salt Spray 48H

Electrical Specifications:

Impedance: 50Ω

Working Frequency: 0-3GHz

Durability: 500Cycles

Red Dustproof Cap

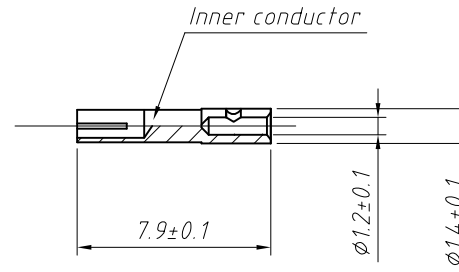
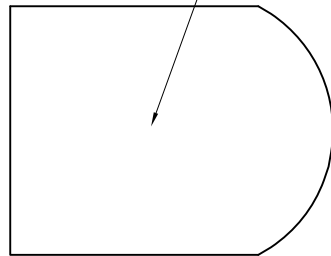

Order Information

L-KLS1-SMA013-RG58C

RG-58C Cable

SMA Cable Connector

Part Number

RoHS

GENERAL TOLERANCE	PROJECTION		Description:
X. ±0.50	UNITS	mm	SMA Cable Connector
.X ±0.25	SCALE	1:1	Straight (Plug, Female, 50Ω) RG-58, RG-55
.XX ±0.10	Draw by:	Jenny	KLS P/N: L-KLS1-SMA013-RG58C
ANGLE TOLERANCE	Check by:		NingBo KLS ELECTRONIC CO., L TD.
X. ±5°	Date	2018-03-01	
.X ±3°	SHEET	1 OF 1	
.XX ±2°			