

RoHS Compliance

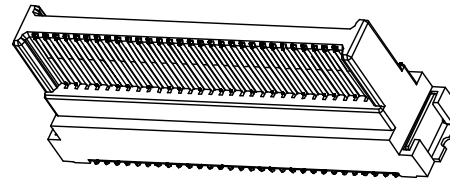

Material and Plated
 1.Housing:Thermoplastic,UL 94V-0
 2.Contact:Copper Alloy
 3.Plated:Gold Plated

Specifications:
 1.Current Rating:0.5A AC/DC
 2.Contact Resistance:100mΩ. max.
 3.Insulation Resistance:500MΩ. min.
 4.Withstanding Voltage:250V AC for one minute
 5.Operating Temperature Range:-40°C to + 105°C

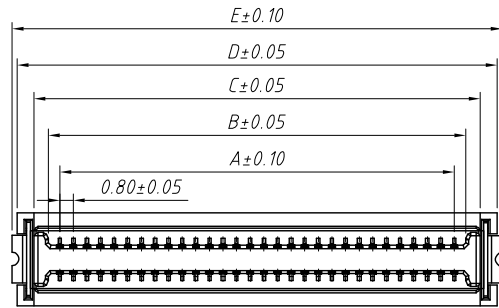
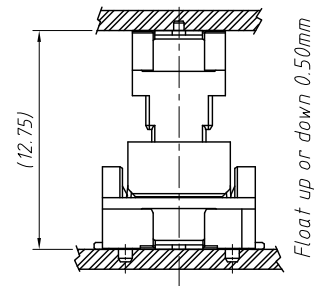
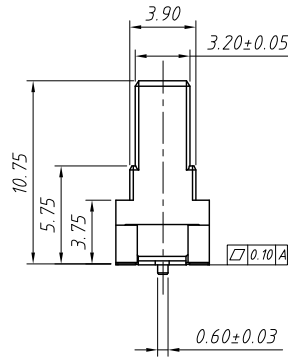
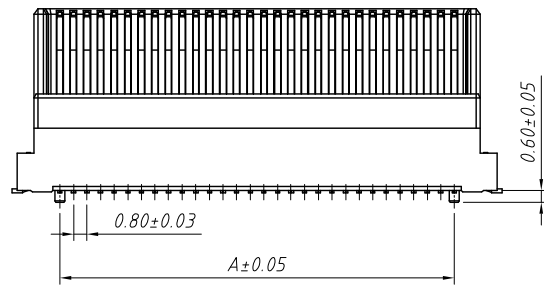

Specifications
 Mating force:40.0 kgf Max
 Unmatting force:4.0kgf Min
 Durability:30cycles

Mating Height Dimension

P/N Plug	P/N Socket	Matting Height
B0108-110M	B0108-610F	12.75

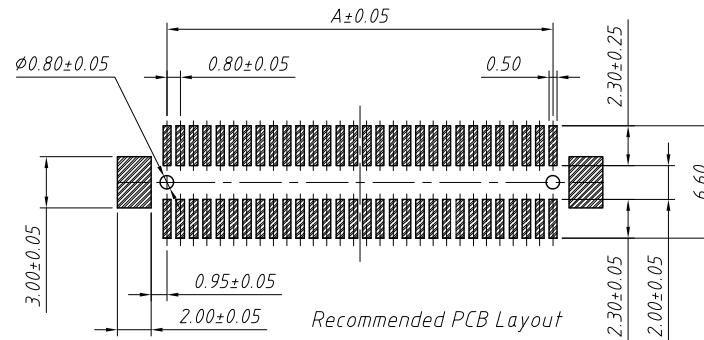
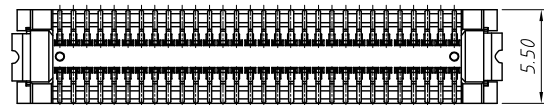

Order Information:

L-KLS1-B0108-110MXX-T3R

L: RoHS
 Board To Board
 Pitch-0.80mm
 Height-10.75mm
 Type:M-Male
 XX-No. Of Contact
 Installation mode:
 T=SMD Without Post,T3=SMD With Post
 Packing:R=Reel T=Tube

Circuit	A	B	C	D	E
20	7.20	8.50	10.20	12.20	12.80
30	11.20	12.50	14.20	16.20	16.80
40	15.20	16.50	18.20	20.20	20.80
50	19.20	20.50	22.20	24.20	24.80
60	23.20	24.50	26.20	28.20	28.80
70	27.20	28.50	30.20	32.20	32.80
80	31.20	32.50	34.20	36.20	36.80
90	35.20	36.50	38.20	40.20	40.80
100	39.20	40.50	42.20	44.20	44.80
110	43.20	44.50	46.20	48.20	48.80
120	47.20	48.50	50.20	52.20	52.80

ANGLE TOLERANCE	PROJECTION	Description:
±3°		0.8mm Board To Board Plug Assembly 10.75mm Height
GENERAL TOLERANCE	UNITS	mm
x.x ±0.30	SHEET SIZE	A4
x.xx ±0.20	Draw:	Daniel 2020-11-11
x.xxx ±0.10	Check:	Daniel 2020-11-11



NingBo KLS ELECTRONIC CO.,L TD.

RoHS Compliance

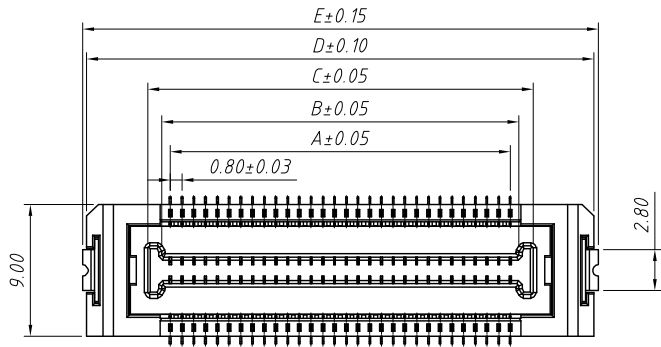

Floating left and right 0.70mm

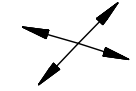

Floating back and forth 0.70mm

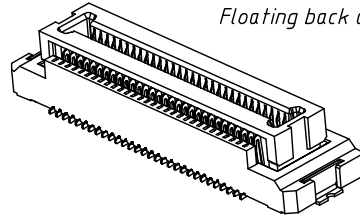

Material and Plated
 1.Housing:Thermoplastic,UL 94V-0
 2.Contact:Copper Alloy
 3.Plated:Gold Plated

Specifications:
 1.Current Rating:0.5A AC/DC
 2.Contact Resistance:100mΩ. max.
 3.Insulation Resistance:500MΩ. min.
 4.Withstanding Voltage:250V AC for one minute
 5.Operating Temperature Range:-40°C to + 105°C

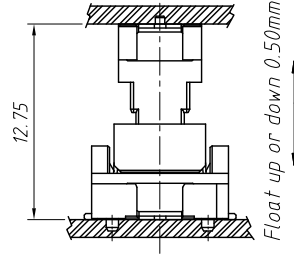
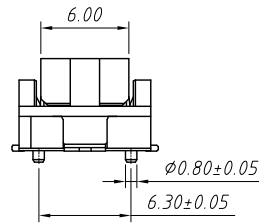
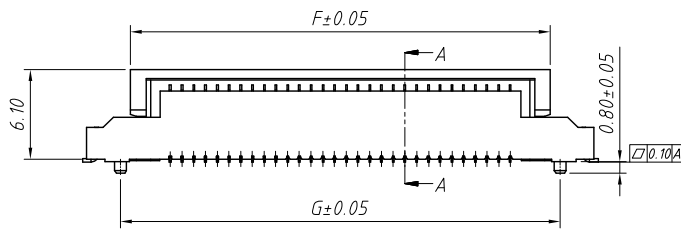

Specifications
 Mating force:40.0 kgf Max
 Unmating force:4.0kgf Min
 Durability:30cycles

Mating Height Dimension

P/N Plug	P/N Socket	Mating Height
B0108-110M	B0108-610F	12.75

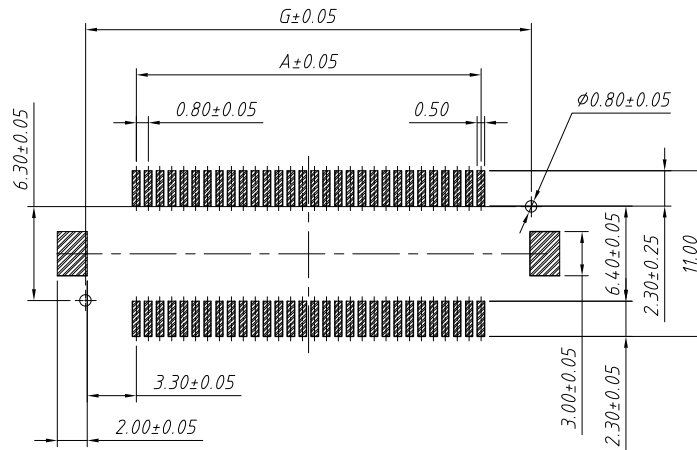
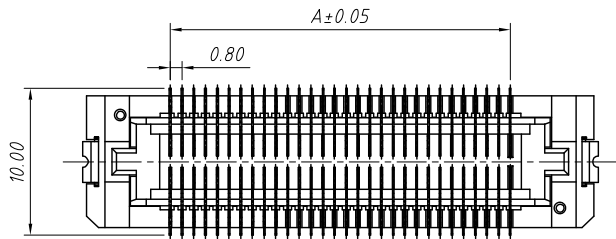

Recommended PCB Layout

Order Information:
 L-KLS1-B0108-610FXX-T3R

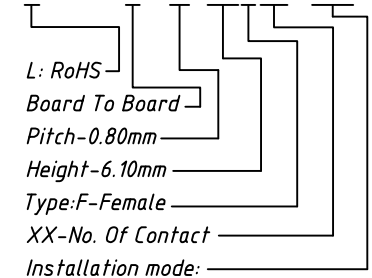

T=SMD Without Post, T3=SMD With Post
 Packing:R=Reel T-Tube

Circuit	A	B	C	D	E	F	G
20	7.20	8.40	10.30	18.60	19.20	12.65	14.00
30	11.20	12.40	14.30	22.60	23.20	16.65	18.00
40	15.20	16.40	18.30	26.60	27.20	20.65	22.00
50	19.20	20.40	22.30	30.60	31.20	24.65	26.00
60	23.20	24.40	26.30	34.60	35.20	28.65	30.00
70	27.20	28.40	30.30	38.60	39.20	32.65	34.00
80	31.20	32.40	34.30	42.60	43.20	36.65	38.00
90	35.20	36.40	38.30	46.60	47.20	40.65	42.00
100	39.20	40.40	42.30	50.60	51.20	44.65	46.00
110	43.20	44.40	46.30	54.60	55.20	48.65	50.00
120	47.20	48.40	50.30	58.60	59.20	52.65	54.00

ANGLE TOLERANCE	PROJECTION	Description:
±3°		Pitch 0.8mm Board to Board Connector H12.75mm
GENERAL TOLERANCE	UNITS	mm
x.x ±0.30	SHEET SIZE	A4
x.xx ±0.20	Draw:	Daniel 2020-11-11
x.xxx ±0.10	Check:	Daniel 2020-11-11



NingBo KLS ELECTRONIC CO.,L TD.