

1
RoHS Compliance

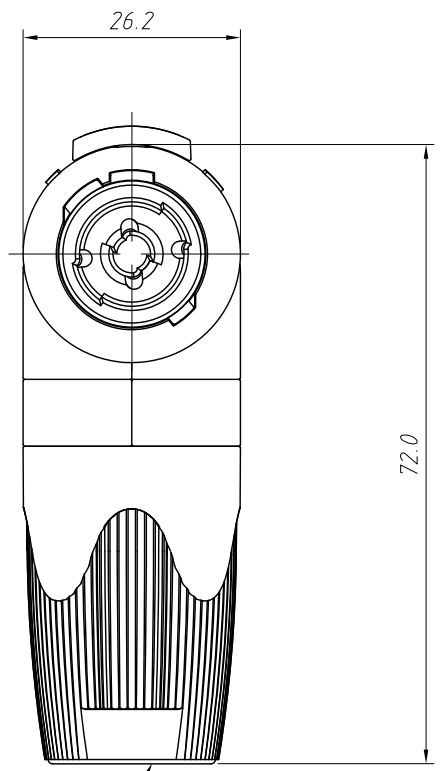
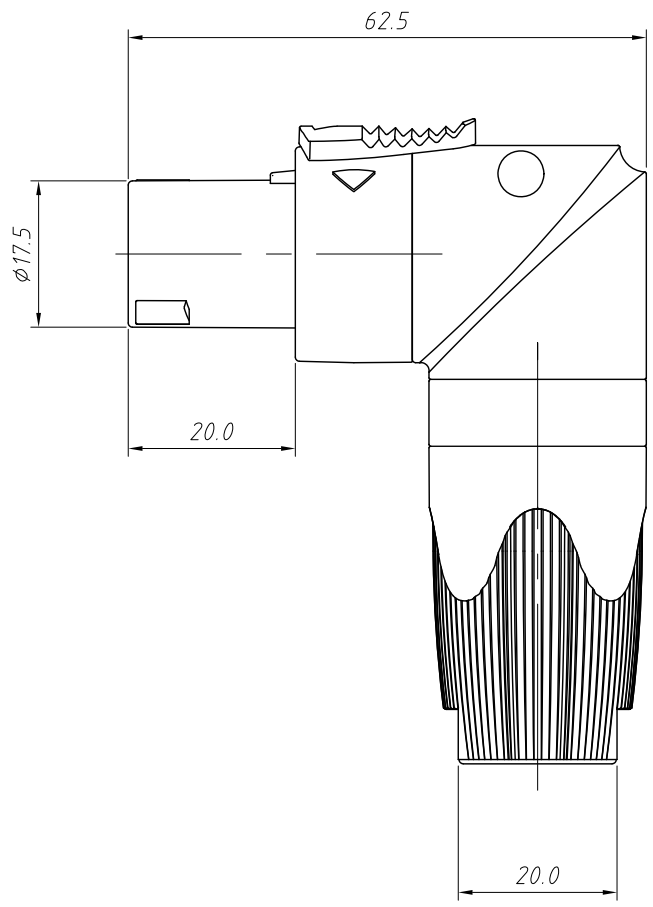

Cable OD 6.0-11.0mm

- Electrical:**
- 1.Voltage Rating: 250VAC
 - 2.Current Rating: 15A Max.
 - 3.Contact Resistance: 30mΩ Max.
 - 4.Insulation Resistance: 1000MΩ Min.
 - 5.Withstanding Resistance :1000VAC Min.

- Mechanical:**
- 1.Durability: 1000 cycles Min.
 - 2.Insertion Force: 5~20N
 - 3./withdrawal Force: 5~20N.

Order Information:
 L-KLS1-SL P-0606-04-BL

L: RoHS
 speakON series
 Type: _____
 S- Socket P- Plug
 Order Number _____
 No. of 04 pins _____
 Color: BL - Blue

ANGLE TOLERANCE	PROJECTION	Description:
±3°		4 pole speakON connectors Right angle Plug
GENERAL TOLERANCE	UNITS	mm
x.x ±0.30	SHEET SIZE	A4
x.xx ±0.20	Draw:	Daniel 2021-08-28
x.xxx ±0.10	Check:	Daniel 2021-08-28
		KLS P/N: L-KLS1-SLP-0606-04-BL
		NingBo KLS ELECTRONIC CO.,L TD.