

AV-F9225



SIZE:

92x92x25mm

construction:

Glass Fiber reinforced plastic;
Impeller and housing PBT

OPERATING TEMPERATURE:

Sleeve bearing -10°C to +70°C

INSULATION RESISTANCE:

10meg Ohm min, at 500 VDC
(between frame and terminal)

DIELECTRIC STRENGTH:

5mA max, at 500 VAC 60Hz one minute
(between frame and terminal)

Dimensions Drawing

Unit:mm

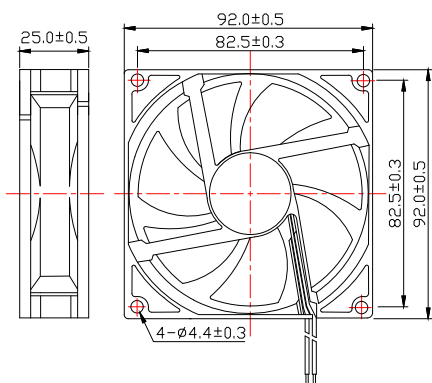

Characteristic Curves

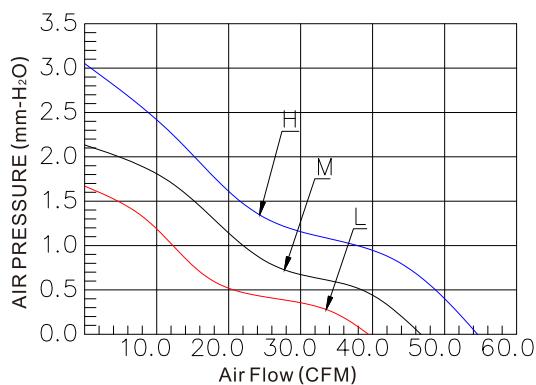

Specifications

Carton Specifications (Unit: cm):49x26x40 QTY:200pcs GW:14.75Kg

Model	Bearing Type	Rated Voltage	Operation Voltage	Current	Speed	Air Flow	Static Pressure	Noise Level	Weight
		VDC	VDC	A	RPM	CFM	mmH ₂ O	dBA	g
AV-F9225HS	Sleeve	12	10.8~13.2	0.35	4000	54.73	3.04	32.81	70
AV-F9225MS	Sleeve	12	10.8~13.2	0.25	3000	46.46	2.11	28.58	70
AV-F9225LS	Sleeve	12	10.8~13.2	0.16	2000	39.87	1.67	25.87	70
AV-F9225HB	Ball	12	10.8~13.2	0.35	4000	54.73	3.04	32.81	70
AV-F9225MB	Ball	12	10.8~13.2	0.25	3000	46.46	2.11	28.58	70
AV-F9225LB	Ball	12	10.8~13.2	0.16	2000	39.87	1.67	25.87	70
AV-F9225HS24	Sleeve	24	21.6~26.4	0.25	4000	54.73	3.04	32.81	70
AV-F9225MS24	Sleeve	24	21.6~26.4	0.20	3000	46.46	2.11	28.58	70
AV-F9225LS24	Sleeve	24	21.6~26.4	0.07	2000	39.87	1.67	25.87	70
AV-F9225HB24	Ball	24	21.6~26.4	0.25	4000	54.73	3.04	32.81	70
AV-F9225MB24	Ball	24	21.6~26.4	0.20	3000	46.46	2.11	28.58	70
AV-F9225LB24	Ball	24	21.6~26.4	0.07	2000	39.87	1.67	25.87	70